

PRODUCT No. 4434

Metal container for swivel forks – 1300 L



(Illustrative photograph)

Technical data

| | |
|------------------|-------------|
| Material | Steel sheet |
| Capacity | 1300 l |
| Weight | 121,5 kg |
| Load capacity | 500 kg |
| Skid distance | 525 mm |
| Pouch dimensions | 175 x 80 mm |
| Width | 1200 mm |
| Depth | 1200 mm |
| Height | 950 mm |

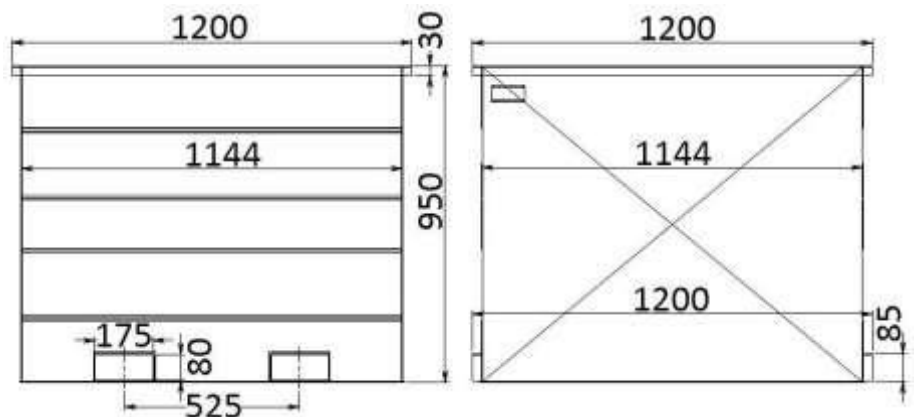

Attributes

- Made of high quality steel sheet.
- Equipped with an integrated adapter for manipulation by fork-lift machinery.
- Emptying of the container can be done by means of the forks with swivel mechanism on fork-lift machinery.
- Suitable for storage and transportation of raw materials, semi-finished products or municipal and separated waste.
- Stack only if the containers are empty (stack of 3 pcs). It is not possible to manipulate with container when stacking.

Color variations

- Standardly blue.

Product purpose

- Designed for manipulation with waste/material by fork-lift machinery.

Additions

- Do not exceed the technical specifications on the label.