

PRODUCT No. 1262

Catching basin without grate - varnished



(Illustration photograph)

Technical data

Material	Steel sheet
Sheet thickness	3 mm
Finishing (basin)	Varnished - blue
Weight	60 kg
Load capacity	1200 kg
Capacity	220 l
Width	1200 mm
Depth	1200 mm
Height	160/260 mm

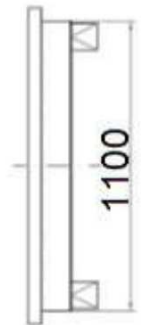
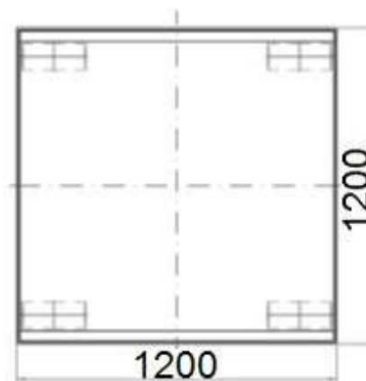
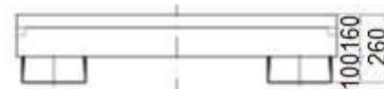

Attributes

- Catching basin for storing of 200 l barrels or smaller containers.
- Equipped with pouches for manipulation by fork-lift machinery.
- Catching basin must be in an empty state when manipulated by fork-lift machinery.

Color variations

- Basin – varnished (Blue).

Product purpose

- Designed for containment of unwanted leakage of liquids.